

Integrated Double DishDrawer Dishwasher, Sanitise

Series 9 | Integrated

Panel Ready



Integrating into your kitchen design seamlessly, each drawer fits a half load that you can load and wash independently.

- Knock to pause function is perfect if you miss a dish
- Six wash programs, as well as additional Quick wash, Sanitise and Extra Dry options
- Flexible racking can be folded down to fit bigger dishes

- Customise with your own front panel and handle to match your kitchen cabinetry, or choose our stainless steel panel

DIMENSIONS

Height	820 - 880 mm
Width	599 mm
Depth	553 mm

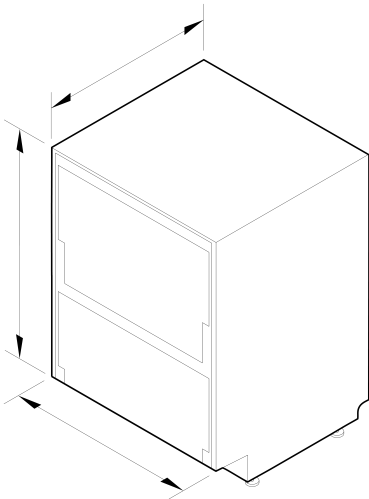

FEATURES & BENEFITS

Ease Of Use
DishDrawer™ Dishwashers are as easy to open and close as kitchen drawers and can be conveniently positioned at bench height for ease of loading and minimal bending. Flexible racking allows you to make adjustments to fit in a variety of dishes.

Independent Wash
With the ability to use both drawers independently and select different wash programs, the DishDrawer™ Dishwasher can wash everything from fine glass and crystal to heavily soiled pots and pans.

True Half Load
Each drawer holds a true half load for guilt-free small washes and fast turnaround of your dishes. Both drawers operate independently so different wash cycles can run simultaneously to accommodate a variety of loads.

Quick, Sanitise And Extra Dry Options
The Quick wash modifier delivers a faster wash while maintaining performance. The Sanitise option provides extra protection killing 99.9% of bacteria in the final rinse. The Extra Dry setting is perfect for plastic dishes.

Knock To Pause
These DishDrawer™ Dishwashers have a knock to pause function – a knock on the front panel will pause the dishwasher.

Quiet Performer
Running at a very low decibel rating, these DishDrawer™ Dishwashers do their job without making a fuss. The combination of intelligent technology and simple mechanics means greater reliability and excellent wash performance.

SPECIFICATIONS

Accessories (included)	
Cutlery basket	•
Kickstrip	true
Knife clip and multipurpose clip	•



Accessories (sold separately)

Door panel black stainless steel	ADDD60DPB	Energy saving delay start option of up to 12 hours	•	Warranty	
Door panel recessed handle black stainless steel	ADDD60DNB	Internal wash selector	•	Parts and labour	1 year
Door panel recessed handle matte black glass	ADDD60DZB	Keylock	•		
Door panel recessed handle stainless steel	ADDD60DNX	Knock to pause	•	Wash Program Modifiers	
Door panel stainless steel	ADDD60DPX	Rinse aid indicator light	•	Extra Dry	•
Handle kit Contemporary square fine, aluminium	AHD5DDDW60S			Quick	•
Handle kit Contemporary square fine, black	AHD5DDDW60B			Sanitise	•
				Wash modifiers	3
Capacity and loading		Features		Wash Programs	
Accommodates round plates up to	280mm	Built-in water softener	•	Delicate	•
Adjustable height, foldable cupracks	•	Fan assisted drying	•	Eco	•
Fold down tines	•	Flood protection	•	Fast	•
Pitch adjustable tines	•	Flow through detergent dispenser	•	Heavy	•
Place settings	16	Motor type	BLDC	Medium	•
Place settings per drawer	8	Quiet operation	•	Rinse	•
		SmartDrive™ technology	•	Wash programs	6
Consumption		Performance		Water connection	
Cleaning Index	1.16	Noise on standard cycle top drawer	43 dBA	Water pressure	100kPa - 1000kPa
Drying Index	0.97			Water supply	3/4" BSP (20mm) Connector Water Inlet Hose
Energy consumption	0.61kWh/cycle per drawer	Power requirements			
Water consumption	8L per drawer	Amperage	10A		
		Supply frequency	50Hz		
		Supply voltage	220 - 240V		
Controls		Product dimensions		SKU	82295
Electronic fault/Diagnostic indicator	•	Depth	553 mm		
End of cycle beeps	•	Height	820 - 880 mm		
		Width	599 mm		

The product dimensions and specifications in this page apply to the specific product and model. Under our policy of continuous improvement, these dimensions and specifications may change at any time. You should therefore check with Fisher & Paykel’s Customer Care Centre to ensure this page correctly describes the model currently available. © Fisher & Paykel Appliances Ltd 2020

Our In-use Energy Carbon Emissions Estimate is designed to assist customers in making informed purchasing decisions when comparing different Fisher & Paykel products. For example, a heat pump dryer typically has a lower In-use Energy Carbon Emissions Estimate than a vented dryer.

Other product downloads available at fisherpaykel.com

- [↓](#) 2D-DWG DishDrawer™ Dishwasher
- [↓](#) 2D-DXF DishDrawer™ Dishwasher
- [↓](#) Service & Warranty
- [↓](#) Installation Guide 
- [↓](#) Installation Guide ZH
- [↓](#) Planning Guide Integrated Double DishDrawer™ Dishwasher EN
- [↓](#) Quick Start Guide  ZH
- [↓](#) Revit Integrated Double DishDrawer™ Dishwasher
- [↓](#) Rhino Integrated Double DishDrawer™ Dishwasher
- [↓](#) Rhino Integrated Double DishDrawer™ Dishwasher with Door Panel and Contemporary Square Handle
- [↓](#) Sketchup Integrated Double DishDrawer™ Dishwasher
- [↓](#) Sketchup Integrated Double DishDrawer™ Dishwasher with Door Panel and Contemporary Square Handle
- [↓](#) User Guide  ZH
- [↓](#)

Where applicable:

All appliances use energy, and energy usage typically generates carbon emissions. **Fisher & Paykel Appliances’ In-use Energy Carbon Emissions Estimate** indicates carbon emissions from a product’s in-use energy. This is calculated either annually or per cycle, using the product’s market-specific energy label energy consumption data multiplied by the carbon emissions factor for energy in your country or region.