

120cm Series 9 Integrated Insert Wall Rangehood

Series 9 | Integrated

Stainless Steel



- With edge-to-edge extraction, this efficient, stylish rangehood is perfectly hidden away in your cabinetry.
- With five fan speeds, select the perfect extraction rate for your cooking
 - With dimmable LED strip lighting
 - 20m3/hr maximum airflow, or 25m3/hr with extension accessory
 - Dishwasher safe filters that are easy to remove and clean

DIMENSIONS

Height	462 mm
Width	1180 mm
Depth	480 mm

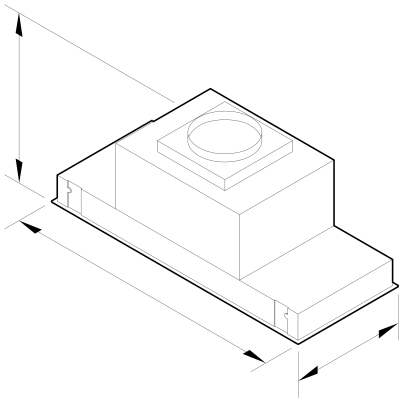

FEATURES & BENEFITS

- Achieve The Invisible**
This high quality integrated rangehood seamlessly blends behind cabinetry in a variety of kitchen layouts. Beautiful in its simplicity, this product has brushed finished surfaces with no visible screws.
- Edge To Edge Extraction**
Filters effectively reach edge to edge, maximising the capture and extraction of steam, odours and grease.

- Full Surface Lighting**
LED lighting illuminates the entire cooktop surface so you can ensure you have the perfect sear or ideal reduction. With dimmable lights featuring fade in and fade out features.
- Easy To Use**
This easy to use rangehood operates with fingertip control of LED-illuminated soft touch buttons. Selected models also come with a remote control.
- Quiet And Efficient**
Powered by a brushless DC motor, the Integrated Rangehood operates more efficiently, more reliably and with less noise than units with AC motors.
- Easy Cleaning**
Multi-layered filters effectively trap grease particles during extraction. Designed for simple removal, they're easy-to-clean and dishwasher safe.
- Simple Installation**
The simple installation process is compatible with most precut cabinetry. The adjustable mounting system can be installed with 16mm to 38mm cabinetry board.

SPECIFICATIONS

Fan ratings	
Maximum air movement	1910 m ³ /hr
Speed 3 sound rating	57 dBA
Installation and cleaning	
Dishwasher safe filters	4
Ducted	Vertical only

Performance

Extraction type	Surface
Fan speeds	5
Filter type	Stainless Steel Baffle

Power requirements

Supply voltage	230 V
----------------	-------

Product dimensions

Depth	480 mm
Height	462 mm
Width	1180 mm

Ventilation features

Auto-off/Run-on timer	•
Dimmable lights	•
Filter cleaning alert	•
Light type	LED strip
Number of light settings	5
Simple sensing	•

SKU	50180
-----	-------

The product dimensions and specifications in this page apply to the specific product and model. Under our policy of continuous improvement, these dimensions and specifications may change at any time. You should therefore check with Fisher & Paykel's Customer Care Centre to ensure this page correctly describes the model currently available. © Fisher & Paykel Appliances Ltd 2020

Other product downloads available at fisherpaykel.com

- [↓](#) 2D-DWG Insert Rangehood
- [↓](#) 2D-DXF Insert Rangehood
- [↓](#) Archicad Integrated Insert Rangehood
- [↓](#) Data Sheet Insert Rangehood
- [↓](#) Service & Warranty
- [↓](#) Installation Guide Rangehood
- [↓](#) Installation Guide Integrated Rangehood
- [↓](#)  ZH
- [↓](#) Revit Integrated Insert Rangehood
- [↓](#) Rhino Integrated Insert Rangehood
- [↓](#) Sketchup Integrated Insert Rangehood
- [↓](#) User Guide Integrated Rangehood

Where applicable:

All appliances use energy, and energy usage typically generates carbon emissions. **Fisher & Paykel Appliances' In-use Energy Carbon Emissions Estimate** indicates carbon emissions from a product's in-use energy. This is calculated either annually or per cycle, using the product's market-specific energy label energy consumption data multiplied by the carbon emissions factor for energy in your country or region.

Our In-use Energy Carbon Emissions Estimate is designed to assist customers in making informed purchasing decisions when comparing different Fisher & Paykel products. For example, a heat pump dryer typically has a lower In-use Energy Carbon Emissions Estimate than a vented dryer.