

# Integrated Double DishDrawer Dishwasher, Sanitise

Series 9 | Integrated

Panel Ready



Integrating into your kitchen design seamlessly, each drawer fits a half load that you can load and wash independently.

- Knock to pause function is perfect if you miss a dish
- Six wash programs, as well as additional Quick wash, Sanitise and Extra Dry options
- Flexible racking can be folded down to fit bigger dishes

- Customise with your own front panel and handle to match your kitchen cabinetry, or choose our stainless steel panel

## DIMENSIONS

Height	820 - 880 mm
Width	599 mm
Depth	553 mm

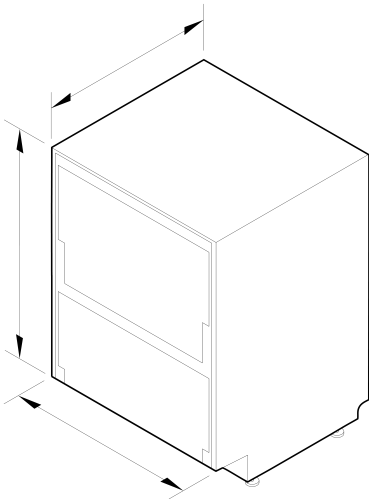

## FEATURES & BENEFITS

## SPECIFICATIONS

### Accessories (included)

Cutlery basket	•
Kickstrip	true
Knife clip and multipurpose clip	•

### Accessories (sold separately)

Door panel black stainless steel	ADDD60DPB
Door panel recessed handle black stainless steel	ADDD60DNB
Door panel recessed handle matte black glass	ADDD60DZB
Door panel recessed handle stainless steel	ADDD60DNX
Door panel stainless steel	ADDD60DPX
Handle kit Contemporary square fine, aluminium	AHD5DDDW60S
Handle kit Contemporary square fine, black	AHD5DDDW60B

### Capacity and loading

Accommodates round plates up to	280mm
Adjustable height, foldable cupracks	•
Fold down tines	•
Pitch adjustable tines	•
Place settings	16
Place settings per drawer	8

### Consumption

Cleaning Index	1.16
Drying Index	0.97

Energy consumption	0.61kWh/cycle per drawer	Supply frequency	50Hz	Water pressure	100kPa - 1000kPa
Water consumption	8L per drawer	Supply voltage	220 - 240V	Water supply	3/4" BSP (20mm) Connector Water Inlet Hose
Controls		Product dimensions			
Electronic fault/Diagnostic indicator	•	Depth	553 mm	SKU	81245
End of cycle beeps	•	Height	820 - 880 mm		
Energy saving delay start option of up to 12 hours	•	Width	599 mm		
Internal wash selector	•			<p>The product dimensions and specifications in this page apply to the specific product and model. Under our policy of continuous improvement, these dimensions and specifications may change at any time. You should therefore check with Fisher &amp; Paykel's Customer Care Centre to ensure this page correctly describes the model currently available. © Fisher &amp; Paykel Appliances Ltd 2020</p>	
Keylock	•	Warranty			
Knock to pause	•	Parts and labour			
Rinse aid indicator light	•				
Features		Wash Program Modifiers		Other product downloads available at fisherpaykel.com	
Built-in water softener	•	Extra Dry	•	<div><div>↓</div><div>2D-DWG DishDrawer™ Dishwasher</div></div> <div><div>↓</div><div>2D-DXF DishDrawer™ Dishwasher</div></div> <div><div>↓</div><div>Service &amp; Warranty</div></div> <div><div>↓</div><div>Installation Guide </div></div> <div><div>↓</div><div>Planning Guide EN</div></div> <div><div>↓</div><div>Planning Guide ZH</div></div> <div><div>↓</div><div>Quick Start Guide  ZH</div></div> <div><div>↓</div><div>Revit Integrated Double DishDrawer™ Dishwasher</div></div> <div><div>↓</div><div>Rhino Integrated Double DishDrawer™ Dishwasher</div></div> <div><div>↓</div><div>Rhino Integrated Double DishDrawer™ Dishwasher with Door Panel and Contemporary Square Handle</div></div> <div><div>↓</div><div>Sketchup Integrated Double DishDrawer™ Dishwasher</div></div> <div><div>↓</div><div>Sketchup Integrated Double DishDrawer™ Dishwasher with Door Panel and Contemporary Square Handle</div></div> <div><div>↓</div><div>User Guide EN</div></div> <div><div>↓</div><div>User Guide ZH</div></div> <div><div>↓</div><div></div></div>	
Fan assisted drying	•	Quick	•		
Flood protection	•	Sanitise	•		
Flow through detergent dispenser	•	Wash modifiers	3		
Motor type	BLDC				
Quiet operation	•	Wash Programs			
SmartDrive™ technology	•	Delicate	•		
		Eco	•		
		Fast	•		
		Heavy	•		
		Medium	•		
		Rinse	•		
		Wash programs	6		
Performance					
Noise on standard cycle top drawer	43 dBA				
Power requirements					
Amperage	10A	Water connection			

**Where applicable:**

All appliances use energy, and energy usage typically generates carbon emissions. **Fisher & Paykel Appliances' In-use Energy Carbon Emissions Estimate** indicates carbon emissions from a product's in-use energy. This is calculated either annually or per cycle, using the product's market-specific energy label energy consumption data multiplied by the carbon emissions factor for energy in your country or region.

Our In-use Energy Carbon Emissions Estimate is designed to assist customers in making informed purchasing decisions when comparing different Fisher & Paykel products. For example, a heat pump dryer typically has a lower In-use Energy Carbon Emissions Estimate than a vented dryer.